

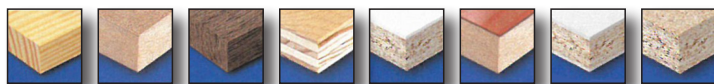

P054 HW Dowel drills with negative spurs



Ottenute da acciaio di elevata resistenza meccanica • Cuspide in HW integrale • 2 taglienti • 2 rasanti • Centri-
• Corpo con 4 scarichi elicoidali • Attacco rettificato con piano di fissaggio e vite di regolazione • Rivestite con resina
fluorocarbonica PTFE per una migliore evacuazione del truciolo • Colore nero per punte rotazione destra • Colore rosso
per punte rotazione sinistra • Da montare su macchine foratrici con l'impiego di mandrini o adattatori • Indicate per
l'esecuzione di fori ciechi sul legno, suoi derivati, laminati e simili

Obtained from steel with a high mechanical resistance • Carbide tip • 2 teeth • 2 spurs • Centre point • Body with
4 spirals • Ground shank with flat and screw • Covered by a fluorine-carbonic resin for a better chip removal • Black
colour for right rotation drills • Red colour for left rotation drills • Use on drilling machines with chucks or adapters
• Indicated to make holes on wood, laminated panels and similar.

● = Ready in stock ■ = Delivery time 20 working days △ = On request

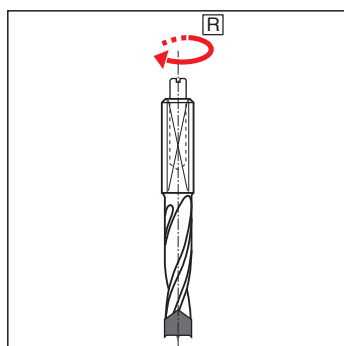
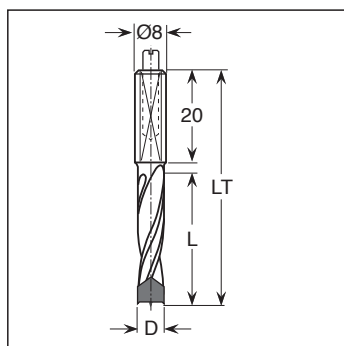

Affilatura con incisore negativo
Sharpening with negative spurs

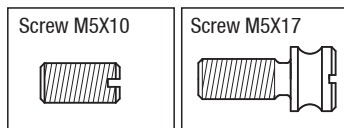
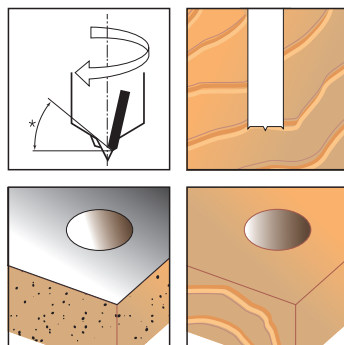

D	L	LT	Left Code	Right Code
5	30	55,5	● P054M005055L	● P054M005055R
6	30	55,5	● P054M006055L	● P054M006055R
7	30	55,5	● P054M007055L	● P054M007055R
8	30	55,5	● P054M008055L	● P054M008055R
9	30	55,5	● P054M009055L	● P054M009055R
10	30	55,5	● P054M010055L	● P054M010055R
12	30	55,5	● P054M012055L	● P054M012055R
5	40	67	● P054M005067L	● P054M005067R
6	40	67	● P054M006067L	● P054M006067R
7	40	67	● P054M007067L	● P054M007067R
8	40	67	● P054M008067L	● P054M008067R
9	40	67	● P054M009067L	● P054M009067R
10	40	67	● P054M010067L	● P054M010067R
12	40	67	● P054M012067L	● P054M012067R
Spec.			P054M99L	P054M99R

■ Utensili non a magazzino, quantità minima d'ordine: **20 pezzi**.
Tools not ready in stock minimum order quantity: **20 pieces**.

SPARE PARTS

Type	Dimensions	Code
Screw	M5X10	● WV510
Screw	M5X17	● WV072

Chipboard

RPM	Feed Speed
3000	0,8 m/min
4000	1,5 m/min
5000	2 m/min
6000	2,5 m/min
8000	2,8 m/min

MDF-Wood

RPM	Feed Speed
3000	0,6 m/min
4000	1,0 m/min
5000	1,4 m/min
6000	1,8 m/min
8000	2,0 m/min

The data are indicative only, MW is not responsible for any incorrect application

TAGLIO / SEZIONATURA
SAWING

DIAMANTE
DIAMOND

FRESATURA
CUTTING

PANTOGRAFATURA
ROUTING

FORATURA
BORING

MANDRINI / ATTACCHI
CHUCKS & CLAMPING SYSTEM

RICAMBI E LAVORAZIONI SUPP.
SPARE PARTS & ADD. WORKING