

# Tool holders Type HSK 63E DIN 69893

## Collet chucks holders for Collets ER 16-25-32-40, ORT25

Code	Description	Collet Type	L1	L	D	Capacity
<b>WE237</b>	Collet chucks holders with nut	<b>ER16</b>	50	60	28	1/10
<b>WE238</b>	Collet chucks holders without nut	<b>ER16</b>	50			
<b>WE239</b>	Collet chucks holders with Lh nut	<b>ER16</b>	50	60	28	
<b>WE240</b>	Collet chucks holders without Lh nut	<b>ER16</b>	50			
<b>WE242-L100</b>	Collet chucks holders with nut	<b>ER16</b>	90	100	22	
<b>WE243-L160</b>	Collet chucks holders without nut	<b>ER16</b>	150	160	22	
<b>WE241</b>	Collet chucks holders with nut	<b>ER25</b>	50	60	42	1/16
<b>WE243</b>	Collet chucks holders without nut	<b>ER25</b>	50			
<b>WE245</b>	Collet chucks holders with Lh nut	<b>ER25</b>	50	60	42	
<b>WE247</b>	Collet chucks holders without Lh nut	<b>ER25</b>	50			
<b>WE244-L100</b>	Collet chucks holders with nut	<b>ER25</b>	90	100	35	
<b>WE245-L160</b>	Collet chucks holders without nut	<b>ER25</b>	150	160	35	
<b>WE204</b>	Collet chucks holders with nut	<b>ER32</b>	60	70	50	1/20
<b>WE208</b>	Collet chucks holders without nut	<b>ER32</b>	60			
<b>WE214</b>	Collet chucks holders with Lh nut	<b>ER32</b>	60	70	50	
<b>WE216</b>	Collet chucks holders without Lh nut	<b>ER32</b>	60			
<b>WE246-L100</b>	Collet chucks holders with nut	<b>ER32</b>	87,5	100	50	
<b>WE247-L160</b>	Collet chucks holders without nut	<b>ER32</b>	147,5	160	50	
<b>WE222</b>	Collet chucks holders with nut	<b>ER40</b>	60	70	63	3/30
<b>WE224</b>	Collet chucks holders without nut	<b>ER40</b>	60			
<b>WE232</b>	Collet chucks holders with Lh nut	<b>ER40</b>	60	70	63	
<b>WE234</b>	Collet chucks holders without Lh nut	<b>ER40</b>	60			
<b>WE222-L100</b>	Collet chucks holders with nut	<b>ER40</b>	83,5	100	63	
<b>WE222-L160</b>	Collet chucks holders without nut	<b>ER40</b>	143,5	160	63	
<b>WE226</b>	Collet chucks holders with nut	<b>ORT25A</b>	60	70	60	3/25
<b>WE228</b>	Collet chucks holders without nut	<b>ORT25A</b>	60			
<b>WE236</b>	Collet chucks holders with Lh nut	<b>ORT25A</b>	60	70	60	
<b>WE238</b>	Collet chucks holders without Lh nut	<b>ORT25A</b>	60			

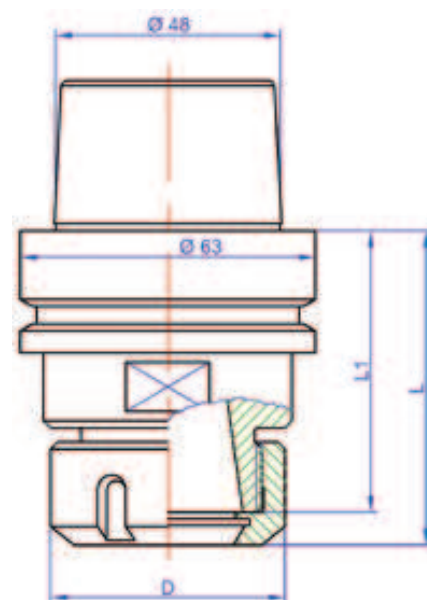

For collets see page from 72 to 79

*Special tool holders are made on request*