

# elite s operating groups

absolute rigidity  
**Planing Fence.**  
High rigid fence with a smooth  
movement thanks to the **central  
locking on round bar.**

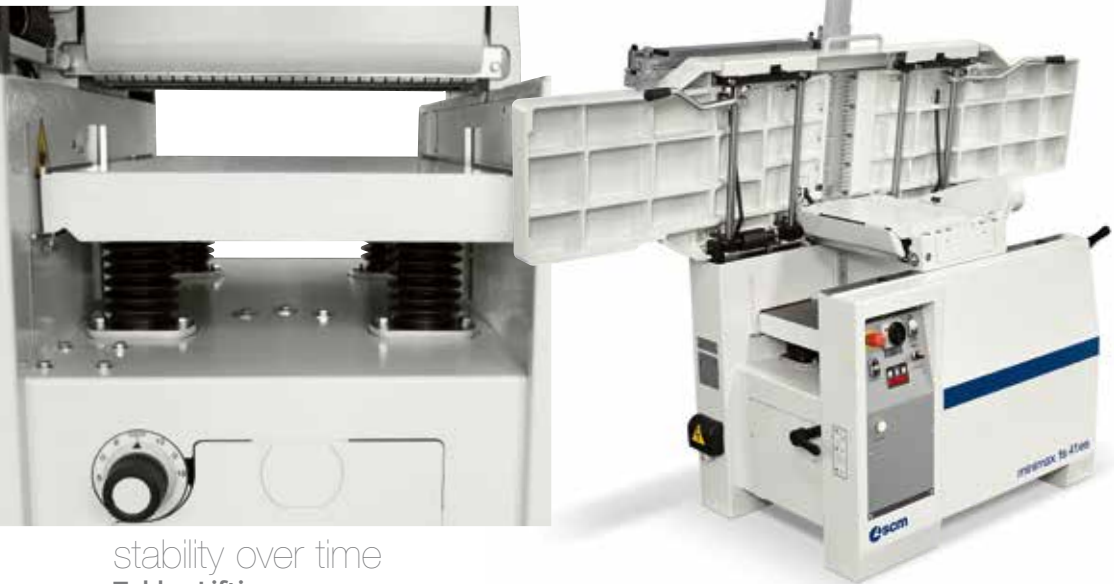

stability over time  
**Tables Lifting.**

Comfortable and precise planing. The *elite s* range adopt ergonomic solutions like the **2200 mm surfacing tables**, in ribbed cast iron, **with simultaneous opening** towards the inside of the machine with a 90° angle. For a maximum long lasting stability the cast iron thickening table lifts on **4 spindles with trapezoidal threads dust protected.**



perfect finishing  
**Planer Cutter Block.**

An optimal planing with minimal effort, thanks to the 95 mm diameter cutter block (120 mm in planers of 520 mm working width) and 4 knives. For an impeccable finish the pressure of the thicknesser feed rollers can be adjusted according to the type of wood machined. The roller infeed (A) has a **helicoidal profile** to guarantee firm and constant work piece feed, while the outfeed roller (B) in sandblasted steel maintains the perfect post-processing finishing.



A

B

The spindle is surrounded by a cast iron "cup" to **protect the internal mechanical components** from shavings and sawdust.

### unsurpassed moulding **Spindle Moulder.**

Maximum stability and rigidity in all working conditions, thanks to a large spindle moulder column made entirely of cast iron.

The 4 standard speed are ideal for any type of machining, from moulding to routing and tenoning, with the possibility to fit tools up to 320 mm of diameter (300 mm no CE).

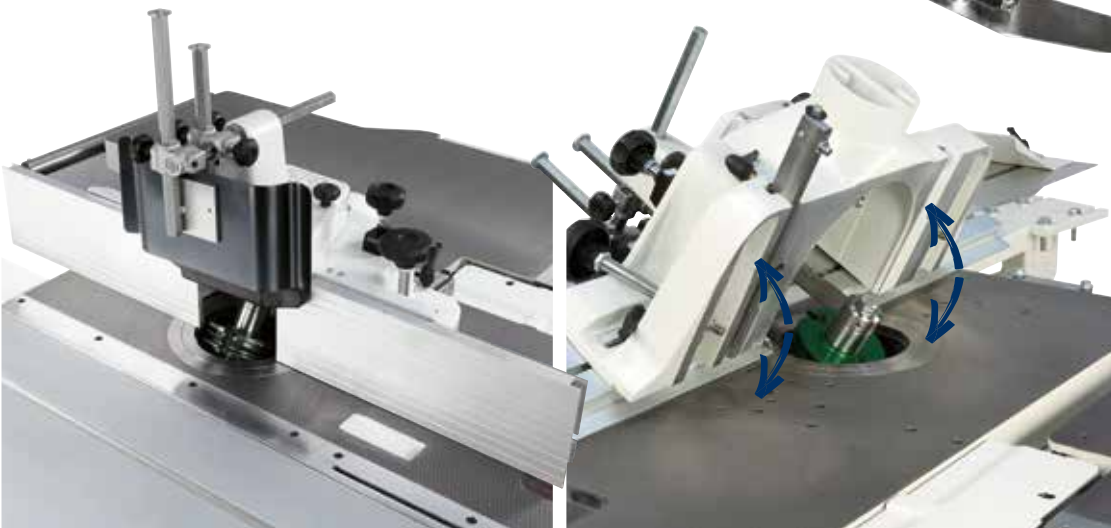

### high-tech devices **Moulder Fence.**

The spindle moulder hood uses a system for adjusting the guides with a rack and it is fitted with a mechanical digital readout. Thanks to the **system of memories** (on *t 55es* and *tw 55es* available as option) the hood can be removed and repositioned without losing the machining position. The maximum tool diameter mounted on the spindle lowered under the table at 90° is 240 mm. On request it is available with a spindle that tilts 45° (towards the inside of the machine).

# elite s dimensions and technical data

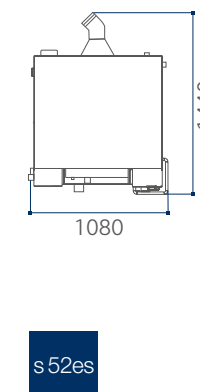
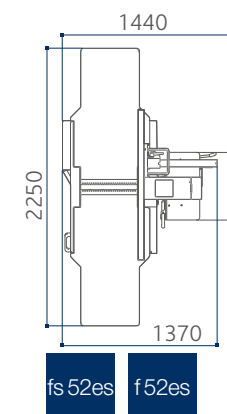
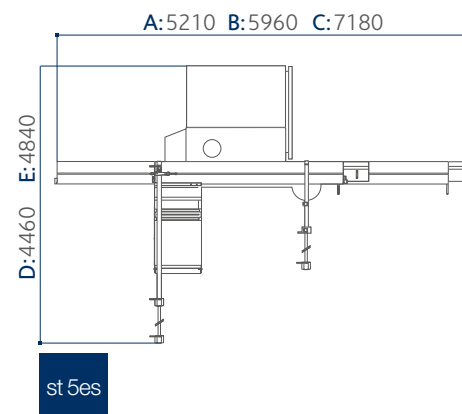
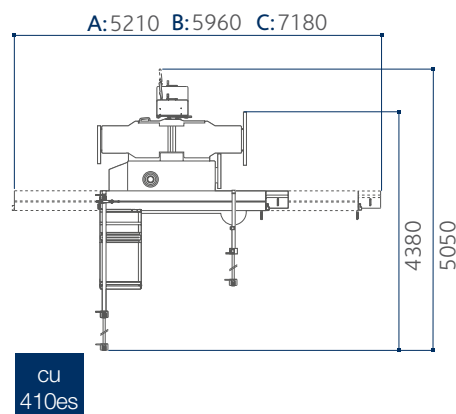

- A with 2250 mm carriage
  - B with 2600 mm carriage
  - C with 3200 mm carriage
  - D with 900 mm cutting width \*
  - E with 1270 mm cutting width \*
- \*at the parallel fence

		cu 410es	st 5es	fs 52es
<b>planer</b>				
Working width	mm	410	-	520
Cutter block diameter (mm)/no. of standard knives	mm/n.	95 / 4	-	120 / 4
Dimensions of standard knives	mm	410 x 30 x 3	-	520 x 30 x 3
Max. stock removal	mm	5	-	5
Surfacing tables total length	mm	2200	-	2250
Thickening tables dimensions	mm	410 x 775	-	520 x 850
Feed speed on thickener	m/min	6 / 12	-	5 / 8 / 12 / 18
Min. ÷ max. working height on thickener	mm	3 ÷ 240	-	3 ÷ 240
<b>circular saw</b>				
Cast iron saw-spindle moulder worktable dimensions	mm	1380 x 465	1380 x 465	-
Saw blade tilting		90° ÷ 45°	90° ÷ 45°	-
Max. saw blade diameter with scoring blade installed	mm	350	350	-
Max. saw blade projection from table at 90°/45°	mm	118 / 84	118 / 84	-
Squaring stroke	mm	2250 ÷ 3200	2250 ÷ 3200	-
Cutting width on parallel fence	mm	1000	900 ÷ 1270	-
<b>spindle moulder</b>				
Max. useful spindle length	mm	125	125	-
Spindle moulder speeds (at 50 Hz)	rpm	3500/6000/8000/10.000	3500/6000/8000/10.000	-
Max. tool diameter when profiling	mm	240	240	-
Max. diameter of tool lowered under the table at 90°	mm	240	240	-
Max. tool diameter when tenoning	mm	320 (300 no CE)	320 (300 no CE)	-
<b>other technical features</b>				
Three-phase motors 5 kW (6,6 hp) 50 Hz - 6 kW (8 hp) 60 Hz		S	S	-
Three-phase motors 7 kW (9,5 hp) 50 Hz <b>with automatic star-delta start</b>		O	O	S
Three-phase motors 9 kW (12 hp) 50 Hz - 11 kW (15 hp) 60 Hz		-	-	O
<b>with automatic star-delta start</b>		-	-	O
Single-phase motors 2,2 kW (3 hp) 50 Hz		-	-	-
Single-phase motors S1 3,6 kW (4,8 hp) 60 Hz		O	O	O
Exhaust outlets diameter	mm	120	120	120

S Standard  
O Option

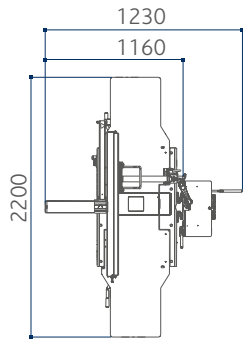

fs 41es f 41es

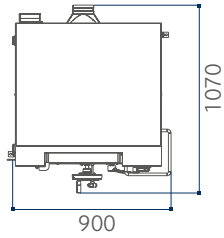

s 41es

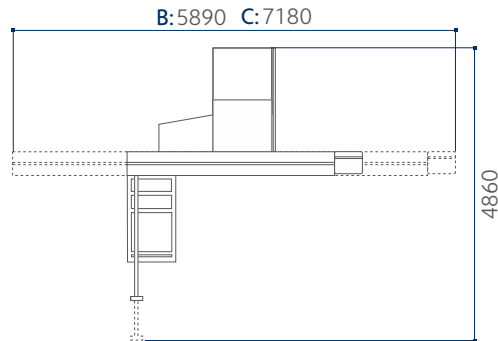

si 400es si 315es

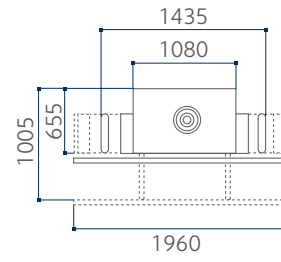

t 55es

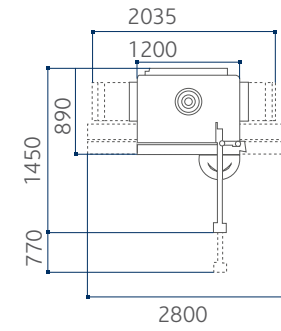

tw 55es

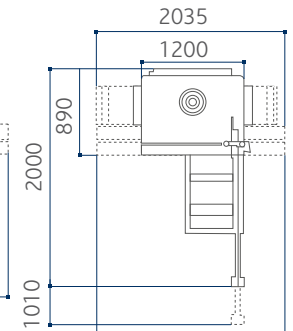

t 55es

with support frame

f 52es	s 52es	fs 41es	f 41es	s 41es	si 400es	si 315es	tw 55es	t 55es
520	520	410	410	410	-	-	-	-
120 / 4	120 / 4	95 / 4	95 / 4	95 / 4	-	-	-	-
520 x 30 x 3	520 x 30 x 3	410 x 30 x 3	410 x 30 x 3	410 x 30 x 3	-	-	-	-
5	5	5	5	5	-	-	-	-
2250	-	2200	2200	-	-	-	-	-
-	520 x 850	410 x 775	-	410 x 775	-	-	-	-
-	5 / 8 / 12 / 18	6 / 12	-	6 / 12	-	-	-	-
-	3 ÷ 240	3 ÷ 240	-	3 ÷ 240	-	-	-	-
-	-	-	-	-	940 x 560	940 x 560	-	-
-	-	-	-	-	90° ÷ 45°	90° ÷ 45°	-	-
-	-	-	-	-	400	315	-	-
-	-	-	-	-	138 / 98	101 / 71	-	-
-	-	-	-	-	2600 ÷ 3200	2600 ÷ 3200	-	-
-	-	-	-	-	1270	1270	-	-
-	-	-	-	-	-	-	125	125
-	-	-	-	-	-	-	3500/6000/8000/10.000	3500/6000/8000/10.000
-	-	-	-	-	-	-	210 ÷ 240	210 ÷ 240
-	-	-	-	-	-	-	240	240
-	-	-	-	-	-	-	320 (300 no CE)	-
S	-	S	S	S	S	S	S	S
O	S	O	-	O	O	O	O	O
-	O	-	-	-	-	-	-	-
-	-	-	-	-	-	-	O	O
O	O	O	O	O	O	O	O	O
120	120	120	120	120	120	120	120	120