

FRESE HW PER MACCHINE "FESTOOL" Z=2

ART. F160

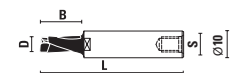

F160.040.R

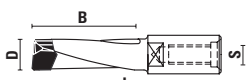

F160.050/100.R

- Da utilizzare su elettrofresatrici Festool® "Domino DF500"
- Adatto per giunzioni "Domino" per la realizzazione di cornici, cassette, corpi di mobili, antine e giunti



S = M6x0,75	D	B	L
F160.040.R ▲ NEW	4	11	38
F160.050.R	5	20	49
F160.060.R	6	28	49
F160.080.R	8	28	49
F160.100.R	10	28	49

▲ HW integrale

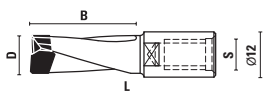

- Da utilizzare su elettrofresatrici Festool® "Domino XL DF700"
- Adatto per giunzioni "Domino" per la realizzazione di antine, tavoli, porte e telai



S = M8x1	D	B	L
F161.080.R NEW	8	50	90
F161.100.R NEW	10	70	90
F161.120.R NEW	12	70	90
F161.140.R NEW	14	70	90



FRESE HW A DOPPIO REFILO Z=2

ART. F108

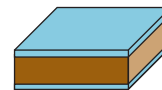
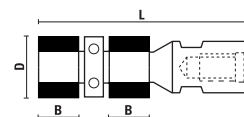

S = M12x1	D	B	L
F108.190.R	19	20	75



Z050.020.N

FRESE HW A RAGGIO CONCAVO Z=2

ART. F110

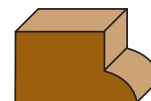
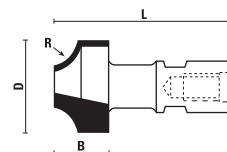

S = M12x1	D	R	B	L
F110.320.R ad esaurimento	32	10	15	60
F110.370.R ad esaurimento	37	12	18	60

FRESE HW A RAGGIO CONCAVO Z=2

ART. F111

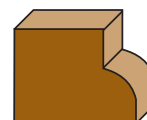
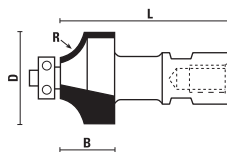

S = M12x1	D	R	B	L
F111.290.R	29	8	13	60
F111.330.R	33	10	15	60
F111.370.R	37	12	17	60
F111.430.R	43	15	20	60
F111.530.R	53	20	25	60