

elite s
combined machines
cu 410es universal combined machine
st 5es saw-spindle moulder



	cu 410es	st 5es
Planer useful working width	mm 410	-
Total length of surfacing tables	mm 2200	-
Max. saw blade diameter with scoring blade installed	mm 350	350
Squaring stroke	mm 2250 + 3200	2250 + 3200
Max. spindle length	mm 125	125
Three-phase motor's starting from	kWhz 5 (6) / 50 (60)	5 (6) / 50 (60)

Find the complete technical specification at page 28



Saw Unit
unique worldwide



Squaring Fence
immediate control



Spindle Moulder
unsurpassed
moulding



Front Handwheels
ergonomic



Sliding Carriage
unrivalled cutting
finishing



SCM
Thundercut
Optimizer/
Sequencer App

Technology and professional performances in the woodworking combined machines, for an unmatched working precision.

elite s
operating
groups

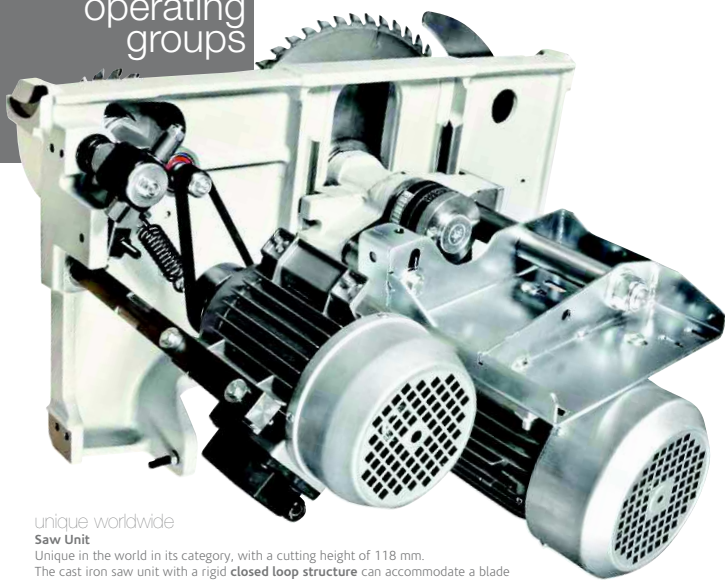

unique worldwide
Saw Unit

Unique in the world in its category, with a cutting height of 118 mm. The cast iron saw unit with a rigid **closed loop structure** can accommodate a blade of 315 and 350 mm diameter (up to 400 mm for *si 400es*) with the **scoring blade mounted**, ensuring perfect and easy cutting of veneer panels and thick solid wood material. The saw blade uses 100% of the motor power, thanks to the **scoring blade with an independent motor as standard**.

The lifting of the blade unit is done by a robust cast iron structure with dovetail system.



The rotation fulcrums of the saw unit have a 120 mm diameter and stand on steady crescent shaped rests that separate it from the base: a rigid reliable solution.

90° ± 45°

The scoring blade is adjustable from the outside without tools and allows fast and accurate positioning with no play.

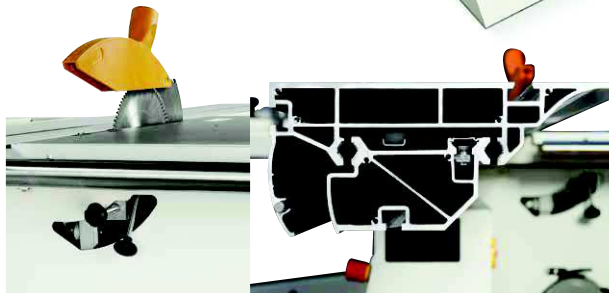

high-tech devices
Controls on Carriage.

Wide range of high-tech devices to make your *elite s* even more powerful and personalized, like the **start/stop pushbuttons for the main blade and scoring blade integrated in the sliding carriage**; very useful when machining large dimensioned work pieces that prevent an easy and safe access to the main machine control panel.



immediate control
Squaring Frame and Fence.

Panel loading is easy on the large squaring frame with an idle roller at the end. The **telescopic squaring fence with the inclined metric scale and two reversible stops** can be used to square panels measuring 3200x3200 mm and for tilted cuts at up to 45° on both sides of the frame.



unrivalled cutting finishing
Sliding Carriage.

Optimal support also to larger pieces, with the **sliding carriage 360 mm wide**. Exceptional precision and smoothness: to secure the guides it is not used glue, since the thickness could affect sliding. They are secured with a procedure of aluminum riveting.

elite s operating groups

**absolute rigidity
Planing Fence.**
High rigid fence with a smooth
movement thanks to the **central
locking on round bar.**

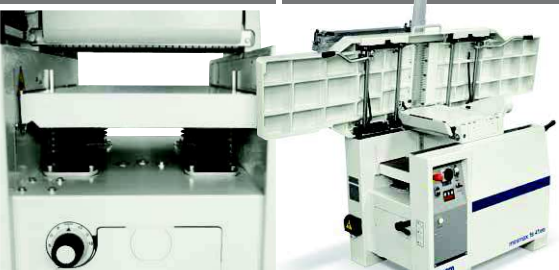
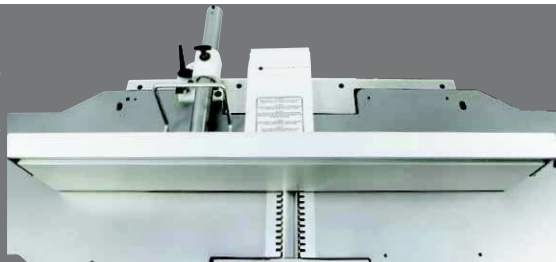

stability over time Tables Lifting.

Comfortable and precise planing. The *elite s* range adopt ergonomic solutions like the **2200 mm surfacing tables**, in ribbed cast iron, **with simultaneous opening** towards the inside of the machine with a **90° angle**. For a maximum long lasting stability the cast iron thickening table lifts on **4 spindles with trapezoidal threads dust protected.**



perfect finishing Planer Cutter Block.

An optimal planing with minimal effort, thanks to the **95 mm diameter cutter block** (120 mm in planers of 520 mm working width) and **4 knives**. For an impeccable finish the pressure of the thicknesser feed rollers can be adjusted according to the type of wood machined. The roller infeed (A) has a **helical profile** to guarantee firm and constant work piece feed, while the outfeed roller (B) in sandblasted steel maintains the perfect post-processing finishing.



The spindle is surrounded by a cast iron "cup" to **protect the internal mechanical components** from shavings and sawdust.

unsurpassed moulding Spindle Moulder.

Maximum stability and rigidity in all working conditions, thanks to a large spindle moulder column made entirely of cast iron. The 4 standard speed are ideal for any type of machining, from moulding to routing and tenoning, with the possibility to fit tools up to 320 mm of diameter (300 mm no CE).



high-tech devices Moulder Fence.

The spindle moulder hood uses a system for adjusting the guides with a rack and it is fitted with a mechanical digital readout. Thanks to the **system of memories** (on *t 55es* and *tw 55es* available as option) the hood can be removed and repositioned without losing the machining position. The maximum tool diameter mounted on the spindle lowered under the table at 90° is 240 mm. On request it is available with a spindle that tilts 45° (towards the inside of the machine).



elite s dimensions and technical data

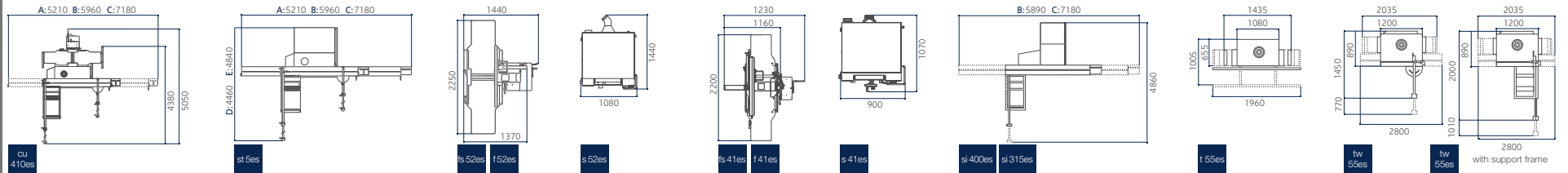

A with 2250 mm carriage
 B with 2600 mm carriage
 C with 3200 mm carriage
 D with 900 mm cutting width *
 E with 1270 mm cutting width *
 * at the parallel fence

	cu 410es	st 5es	fs 52es	f 52es	s 52es	fs 41es	f 41es	s 41es	si 400es	si 315es	tw 55es	t 55es
planer												
Working width	mm 410	-	520	520	520	410	410	410	-	-	-	-
Cutter block diameter (mm)/no. of standard knives	mm/n 95 / 4	-	120 / 4	120 / 4	120 / 4	95 / 4	95 / 4	95 / 4	-	-	-	-
Dimensions of standard knives	mm 410 x 30 x 3	-	520 x 30 x 3	520 x 30 x 3	520 x 30 x 3	410 x 30 x 3	410 x 30 x 3	410 x 30 x 3	-	-	-	-
Max. stock removal	mm 5	-	5	5	5	5	5	5	-	-	-	-
Surfacing tables total length	mm 2200	-	2250	2250	2250	2200	2200	2200	-	-	-	-
Thickening tables dimensions	mm 410 x 775	-	520 x 850	520 x 850	520 x 850	410 x 775	410 x 775	410 x 775	-	-	-	-
Feed speed on thickener	m/min 6 / 12	-	5 / 8 / 12 / 18	5 / 8 / 12 / 18	5 / 8 / 12 / 18	6 / 12	6 / 12	6 / 12	-	-	-	-
Min. → max. working height on thickener	mm 3 → 240	-	3 → 240	3 → 240	3 → 240	3 → 240	3 → 240	3 → 240	-	-	-	-
circular saw												
Cast iron saw-spindle moulder worktable dimensions	mm 1380 x 465	1380 x 465	-	-	-	-	-	-	940 x 560	940 x 560	-	-
Saw blade tilting	90° ± 45°	90° ± 45°	-	-	-	-	-	-	90° ± 45°	90° ± 45°	-	-
Max. saw blade diameter with scoring blade installed	mm 350	350	-	-	-	-	-	-	400	315	-	-
Max. saw blade projection from table at 90°/45°	mm 118 / 84	118 / 84	-	-	-	-	-	-	138 / 98	101 / 71	-	-
Squaring stroke	mm 2250 ± 3200	2250 ± 3200	-	-	-	-	-	-	2600 ± 3200	2600 ± 3200	-	-
Cutting width on parallel fence	mm 1000	900 ± 1270	-	-	-	-	-	-	1270	1270	-	-
spindle moulder												
Max. useful spindle length	mm 125	125	-	-	-	-	-	-	-	-	125	125
Spindle moulder speeds (at 50 Hz)	rpm 350/6000/8000/10.000	350/6000/8000/10.000	-	-	-	-	-	-	-	-	350/6000/8000/10.000	350/6000/8000/10.000
Max. tool diameter when profiling	mm 240	240	-	-	-	-	-	-	-	-	210 ± 240	210 ± 240
Max. diameter of tool lowered under the table at 90°	mm 240	240	-	-	-	-	-	-	-	-	240	240
Max. tool diameter when tenoning	mm 320 (300 no CE)	320 (300 no CE)	-	-	-	-	-	-	-	-	320 (300 no CE)	-
other technical features												
Three-phase motors 5 kW (6,6 hp) 50 Hz - 6 kW (8 hp) 60 Hz	S	S	-	S	-	S	S	S	S	S	S	S
Three-phase motors 9 kW (12 hp) 50 Hz - 11 kW (15 hp) 60 Hz	O	O	S	O	S	O	O	O	O	O	O	O
with automatic star-delta start	-	-	O	-	O	-	-	-	-	-	-	-
Single-phase motors 2,2 kW (3 hp) 50 Hz	-	-	-	-	-	-	-	-	-	-	O	O
Single-phase motors S1 3,6 kW (4,8 hp) 60 Hz	O	O	O	O	O	O	O	O	O	O	O	O
Exhaust outlets diameter	mm 120	120	120	120	120	120	120	120	120	120	120	120

S Standard
 O Option

elite s
main
optional
devices

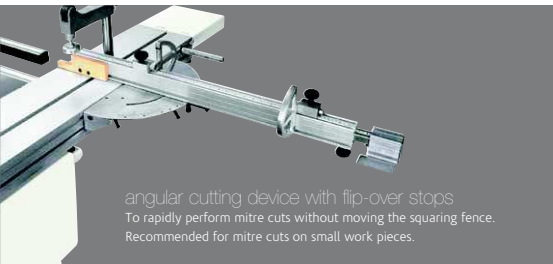

angular cutting device with flip-over stops
To rapidly perform mitre cuts without moving the squaring fence.
Recommended for mitre cuts on small work pieces.



additional table on the sliding carriage
For the support of large dimensioned panels.

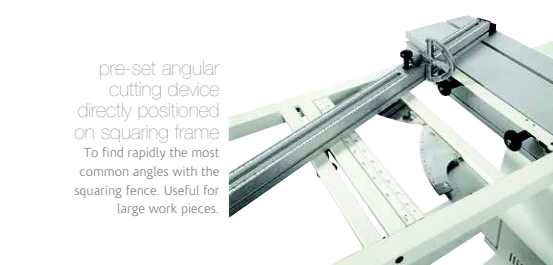

pre-set angular cutting device directly positioned on squaring frame
To find rapidly the most common angles with the squaring fence. Useful for large work pieces.

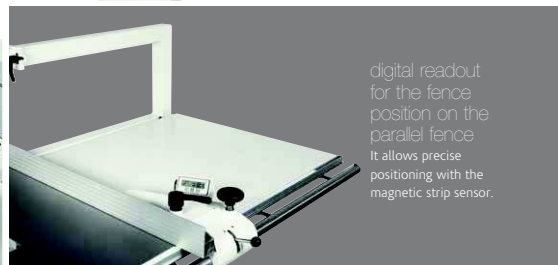

digital readout for the fence position on the parallel fence
It allows precise positioning with the magnetic strip sensor.

tablet holder on the sliding carriage
Compatible with tablets from 8" to 11"



overhead blade protection
For totally safe machining.



"Tersa" cutter block
Automatic knives clamping by means of the centrifugal force ensures safe and precise machining. The system, without fixing screws, makes knives substitution extremely fast.



cast iron mortiser

Drilling holes and mortises are easily carried out. It is equipped with an exhaust hood, 120 mm diameter and 16 mm chuck.

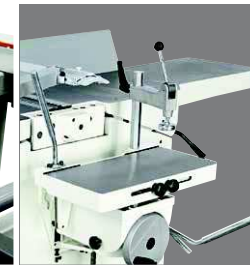

maintenance case for "Xylent" spiralknife

- It consists of:
- 1 cleaning/degreasing liquid bottle for the resins cleaning
 - 1 set dynamometric key
 - 2 bit Torx
 - 10 inserts
 - 5 screws
 - 1 brass bristle brush to clean the spindle with mounted in inserts
 - 1 steel bristle brush to clean the inserts housings



"Xylent" spiralknife cutter block with 3 series of knives
The 3 spiralknives give an exceptional finish. Reduced noise during machining provides a more comfortable working environment. It also improves the dust extraction due to the production of very small chips. Each cutter has 4 tips which can be rotated into the cutting position when worn. Therefore, increasing the production life of the cutter block before knives require replacement.

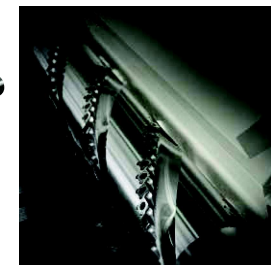

elite s
main
optional
devices



additional overturning
fence for thin work
pieces.
It ensures optimum operator safety
when machining thin work pieces.



chuck with clamp
It allows harder machining thanks
to the stronger bits. The chuck
includes 3 clamps 5/10/16 mm.



Complex
To rapidly obtain angular
cuttings with automatic
self-adjustment of the
stops position.



pushbuttons integrated
in the sliding carriage
The possibility to start or stop the blades
motors from the pushbuttons located at the
ends of the carriage considerably helps when
machining large dimensioned panels.

self-centering chuck
0-16 mm "Wescoott" type
The mortiser spindles can be
rapidly substituted without
the necessity of adjustment.



Ready 3 /
programmed
parallel fence
Automatic parallel
fence positioning,
available for version
with 1 and 3 axes.

thickening
table with two
removable
idle rollers
It assists the feed for
demanding pieces.



thickening table
extension to be used
in infeed or outfeed
It can be installed on the
worktable end side.



Dado set
Mechanical presetting to
use a tool (not included) in
place of the main blade.



digital readouts
On squaring stops with
micrometric adjustment.

elite s main optional devices

interchangeable spindle (A)

For a very quick spindle substitution. Among the spare spindle, it is available also the spindle for router bits. (B)



elite s main optional devices

tenoning table and protection hood

For the tenoning operations on the spindle moulder. It consists of:

- table
- protection hood for tools, 320 mm diameter (300 mm USA/Canada)
- exhaust hood, 120 mm diameter



roller telescopic extensions for spindle moulder

For the machining of work pieces with large dimensions.



electric pre-setting and flip over support for feeder

This solution allows a total exclusion of the device and prevents interference with other parts of the machine.

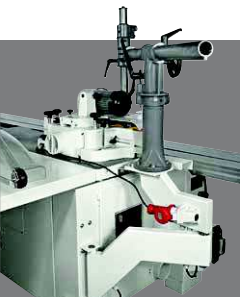

powered handling of the operating groups with digital readouts

For the best precision and easy-to-use.



S Standard
O Option
- Standard for CE and USA/Canada versions

	cu 410es	st 5es	fs 52es	f 52es	s 52es	fs 41es	f 41es	s 41es	si 400es	si 315es	tw 55es	t 55es
"SCM Thundercut" Optimizer/Sequencer App	S	S	-	-	-	-	-	-	S	S	-	-
Angular cutting device with flip-over stops	O	O	-	-	-	-	-	-	O	O	-	-
Pre-set angular cutting device directly positioned on squaring frame	O	O	-	-	-	-	-	-	O	O	-	-
Digital readout for the fence position on the parallel fence	-	O	-	-	-	-	-	-	O	O	-	-
Start/stop pushbuttons for the saw blade and scoring blade integrated in the sliding carriage	O	O	-	-	-	-	-	-	O	O	-	-
Additional table on the sliding carriage	O	O	-	-	-	-	-	-	O	O	-	-
Overhead blade protection	-	O*	-	-	-	-	-	-	O*	O	-	-
"Tersa" cutter block	O	-	O	O	O	O	O	-	-	-	-	-
"Xylent" spiralknife cutter block with 3 series of knives	O	-	O	O	O	O	O	-	-	-	-	-
Maintenance case for "Xylent" spiralknife	O	-	O	O	O	O	O	-	-	-	-	-
Cast iron mortiser	O	-	O	O	-	O	O	-	-	-	-	-
Self-centering chuck 0-16 mm "Wescott" type	O	-	O	O	-	O	O	-	-	-	-	-
Chuck with clamp	O	-	O	O	-	O	O	-	-	-	-	-
Thickening table with two removable idle rollers	-	-	O	-	O	-	-	-	-	-	-	-
Additional overturning fence for thin work pieces	-	-	O	O	-	O	O	-	-	-	-	-
Tenoning table and protection hood	O	O	-	-	-	-	-	-	-	-	O	-
Electric pre-setting and flip over support for feeder	O	O	-	-	-	-	-	-	-	-	O	-
Interchangeable spindle	O	O	-	-	-	-	-	-	-	-	O	O
Roller telescopic extensions for spindle moulder	-	-	-	-	-	-	-	-	-	-	O	O
Powered handling of the operating groups with digital readouts	O	O	O	-	S	O	-	O	O	O	O	-
Complex	O	O	-	-	-	-	-	-	O	O	-	-
Dado set	-	O	-	-	-	-	-	-	O	O	-	-
Digital readouts	O	O	-	-	-	-	-	-	O	O	-	-
Ready 3 / Programmed parallel fence	-	-	-	-	-	-	-	-	O	O	-	-
Tablet holder on the sliding carriage	O	O	-	-	-	-	-	-	O	O	-	-
Thickening table extension to be used in infeed or outfeed	-	-	O	-	O	-	-	-	-	-	-	-

PROMPT AND EXPERT TECHNICAL SUPPORT THROUGH A NETWORK OF 1000 TECHNICIANS AND AN INVENTORY OF 36,000 SPARE PARTS.

HIGHLY SPECIALISED TECHNICIANS, EFFICIENT MANAGEMENT AND 6 SPARE PARTS BRANCHES AROUND THE WORLD GUARANTEE A CLOSE, SAFE AND EFFECTIVE TECHNICAL SUPPORT.

SERVICE

SCM provides a service that goes beyond the purchase, to guarantee the long term performance of your technological production system and peace of mind for your business.

A COMPLETE RANGE OF AFTER-SALES SERVICES

- installation and start-up of machines, cells, lines and systems
- tailored training programs
- telephone support to reduce times and costs when machines are not working
- preventive maintenance programs to guarantee long term performance
- complete renovation of machines and plants to renew the added value of the investments
- custom upgrading to update machines and plants and meet new production requirements

 **scm**service

SPARE PARTS

SCM Group can count on 140 spare parts professionals worldwide to meet any request with real time shipments.



36,000 SPARE PARTS
Our spare parts inventory, with a value of 12 million euros, covers every single machine



SPARE PARTS GUARANTEED
We guarantee also hard to find parts, with 3.5 million euros invested in "critical" spare parts.



IMMEDIATE AVAILABILITY
Over 90% of orders received are carried out the same day thanks to the huge inventory available.



6 BRANCHES AROUND THE WORLD
The spare parts service can count on worldwide support (Rimini, Singapore, Shenzhen, Moscow, Atlanta, São Bento do Sul)



500 SHIPMENTS A DAY

 **scm**spareparts



 **scm**
woodworking technology

THE STRONGEST WOOD TECHNOLOGIES ARE IN OUR DNA

SCM. A HERITAGE OF SKILLS IN A UNIQUE BRAND

Over 65 years of success gives SCM the centre stage in woodworking technology. This heritage results from bringing together the best know-how in machining and systems for wood-based manufacturing. SCM is present all over the world, brought to you by the widest distribution network in the industry.

65+ years history

3 main production sites in Italy

300.000 square metres of production space

20.000 machines manufactured per year

90% export

20 foreign branches

400 agents and dealers

500 support technicians

500 registered patents

In SCM's DNA also strength and solidity of a great Group. The SCM Group is a world leader, manufacturing industrial equipment and components for machining the widest range of materials.

SCM GROUP, A HIGHLY SKILLED TEAM EXPERT IN INDUSTRIAL MACHINES AND COMPONENTS

INDUSTRIAL MACHINERY

Stand-alone machines, integrated systems and services dedicated to processing a wide range of materials.

 **scm**
WOODWORKING TECHNOLOGIES

 **Cms**
TECHNOLOGIES FOR PROCESSING COMPOSITE MATERIALS, ALUMINIUM, PLASTIC, GLASS, STONE, METAL

INDUSTRIAL COMPONENTS

Technological components for the Group's machines and systems, for those of third-parties and the machinery industry.

 **HITECO**
SPINDLES AND TECHNOLOGICAL COMPONENTS

 **es**
ELECTRIC PANELS

 **steelmec**
METALWORK

 **scmfonderie**
CAST IRON



 **scm** | is more
woodworking technology



Company of the Scm Group
registered office:
via Emilia, 77
47921 Rimini, Italia
T. +39 0541 700111
F. +39 0541 700232
sales office:
via Casale, 450
47826 Villa Verucchio, Rimini, Italia
T. +39 0541 674111
F. +39 0541 674274
scm@scmgroup.com
www.scmwood.com

Scm Industria Spa
Professional Workshop Machinery
via Valdicella, 7
47892 Gualdicciolo,
Repubblica di San Marino
scm@scmgroup.com
sales dept. Italy:
T. +378 0549 876911
F. +378 0549 999604
foreign sales dept.:
T. +39 0541 674111
F. +39 0541 674274
www.scmwood.com

The motors powers in this catalogue are expressed in S6,
except where otherwise specified. In this catalogue, machines
are shown in CE configuration and with options. We reserve
the right to modify technical specifications without prior
notice, provided that such modifications do not affect
safety as per CE norms.

rev.01
03/2021

Mic Studio

